







**KEY:**

-  PROPOSED NORTHERN CYCLE ROUTE
-  PROPOSED SHARED USE FOOTWAY
-  PROPOSED CARRIAGEWAY RESURFACING
-  PROPOSED DOUBLE YELLOW LINE RESTRICTIONS - 'AT ANY TIME'
-  EXISTING DOUBLE YELLOW LINES
-  TREE TO BE REMOVED (VARIES SIZES / TYPES, TO BE CONFIRMED AT DETAIL DESIGN STAGE)
-  PROPOSED BOLLARD WITH CYCLE SIGNAGE

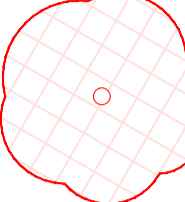

THE MAPPING IS REPRODUCED FROM OR BASED UPON ORDNANCE SURVEY MATERIAL WITH THE PERMISSION OF ORDNANCE SURVEY ON BEHALF OF THE CONTROLLER OF HER MAJESTY'S STATIONERY OFFICE (C) CROWN COPYRIGHT. UNAUTHORISED REPRODUCTION INFRINGES CROWN COPYRIGHT AND MAY LEAD TO PROSECUTION OR CIVIL PROCEEDINGS. LONDON BOROUGH OF HARROW 100019206.

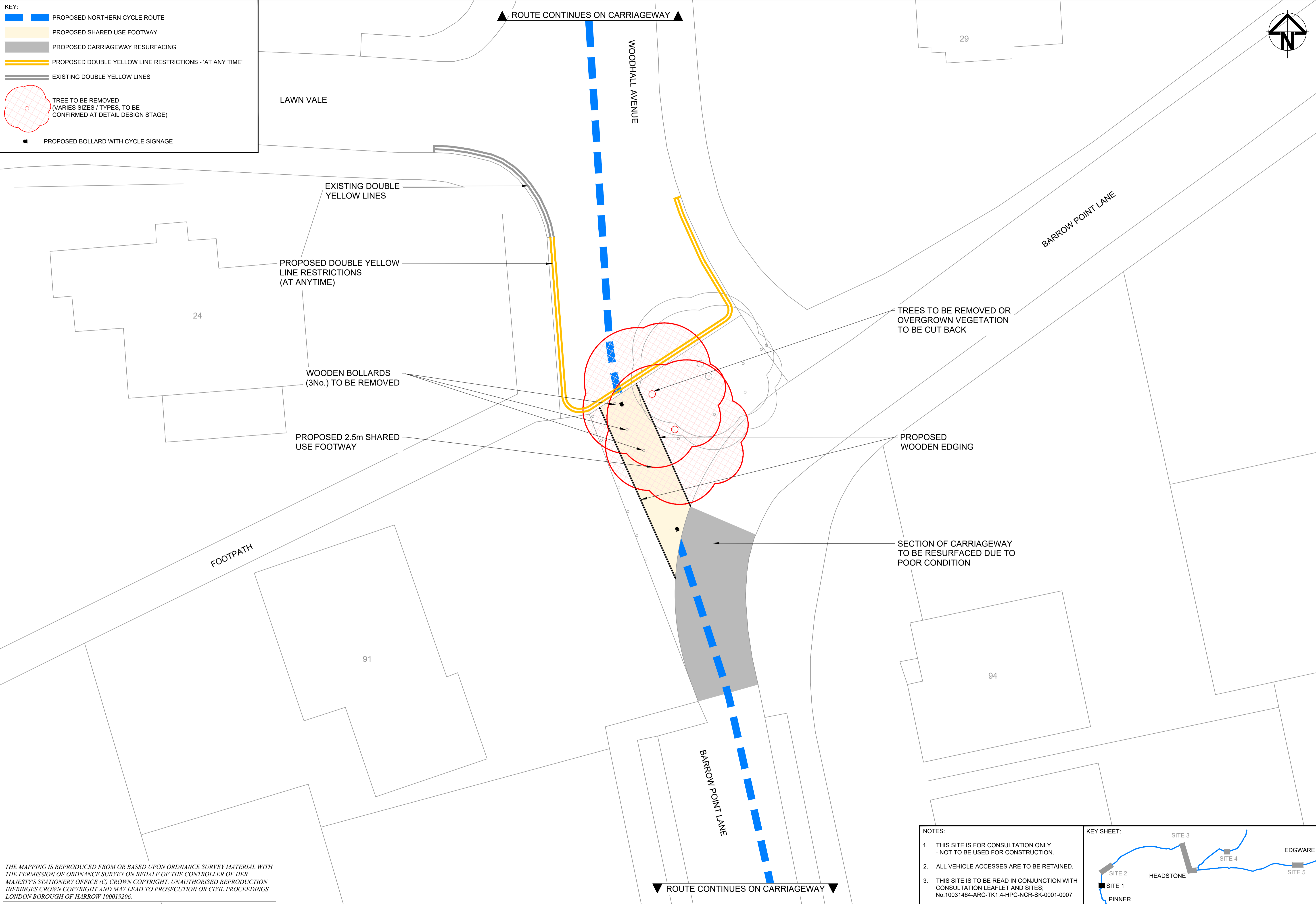
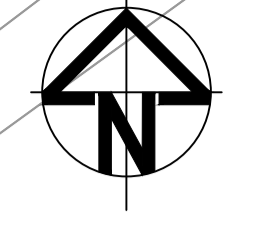
- NOTES:**
1. THIS SITE IS FOR CONSULTATION ONLY - NOT TO BE USED FOR CONSTRUCTION.
  2. ALL VEHICLE ACCESSES ARE TO BE RETAINED.
  3. THIS SITE IS TO BE READ IN CONJUNCTION WITH CONSULTATION LEAFLET AND SITES: No.10031464-ARC-TK1.4-HPC-NCR-SK-0001-0007

